

DTP R HWP 4K 231 D

DTP RECEIVER FOR
HDMI – DECORATOR-STYLE
WALLPLATE

DTP
SYSTEMS

4K UHD



- ▶ Receives HDMI plus control and analog audio up to 230 feet (70 meters) over a shielded CATx cable
- ▶ Supports computer and video resolutions up to 4K
- ▶ HDCP 2.3 compliant
- ▶ Supported HDMI specification features include data rates up to 10.2 Gbps, Deep Color up to 12-bit, 3D, HD lossless audio formats, and CEC pass-through
- ▶ Extron XTP DTP 24 shielded twisted pair cable is strongly recommended for optimal performance
- ▶ Supports EDID and HDCP transmission
- ▶ Bidirectional RS-232 and IR pass-through for AV device control
- ▶ Remote power capability
- ▶ Compatible with all DTP® 230 Series transmitters and DTP-enabled products
- ▶ Highly reliable, energy-efficient external universal power supply included with Tx models

The Extron DTP R HWP 4K 231 D is a single-gang decorator-style receiver that works with Extron DTP®-enabled products to send HDMI, analog audio, and bidirectional control signals up to 230 feet (70 meters) over a shielded CATx cable. It is designed for efficient use at display locations in environments offering limited space. The HDCP-compliant receiver features a convenient one-gang form factor that offers maximum placement flexibility.



Extron Electronics
INTERFACING, SWITCHING AND CONTROL

DESCRIPTION

The Extron **DTP R HWP 4K 231 D** is a single-gang decorator-style receiver that works with Extron DTP-enabled products to send HDMI, audio, and bidirectional RS-232 and IR signals up to 230 feet (70 meters) over a shielded CATx cable. The one-gang form factor provides maximum space efficiency in wall mount, floor box, and furniture mount applications. The DTP R HWP 4K 231 D supports video signals at resolutions up to 4K. It also accepts analog stereo audio signals from a DTP-enabled product over the same shielded twisted pair cable. The wall-mountable design and remote power capability of the DTP R HWP 4K 231 D provide the convenience of placing output connections precisely where they are needed.

The DTP R HWP 4K 231 D enables the reliable transmission of HDMI signals, supporting Deep Color up to 12-bit, CEC pass-through, and embedded HD lossless audio formats. DDC communication of EDID and HDCP is continuously maintained between a source and display, ensuring direct compatibility and optimal signal transmission between devices. For added installation flexibility, the receiver can be remotely powered over the shielded twisted pair cable by a DTP-enabled product. The DTP R HWP 4K 231 D can be integrated with an Extron DTP CrossPoint® Presentation Matrix Switcher, or other DTP-enabled products to support sources at remote locations.

APPLICATION DIAGRAM

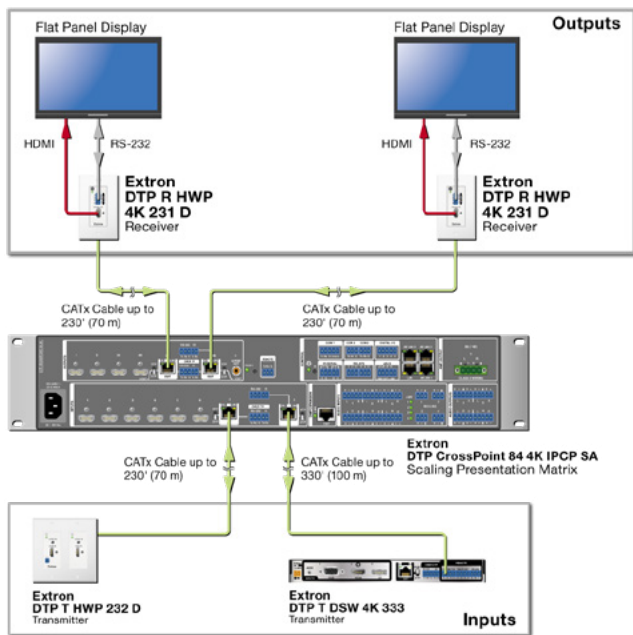

SPECIFICATIONS

TRUE 4K SPECIFICATION

| Max. 4K Capabilities | | |
|--|-----------------|-------------------------|
| Resolution and Refresh Rate | Chroma Sampling | Max Bit Depth per Color |
| 4096 x 2160 at 30 Hz 3840 x 2160 at 30 Hz | 4:4:4 | 8 bit |
| 4096 x 2160 at 60 Hz 3840 x 2160 at 60 Hz | 4:2:0 | 8 bit |

| | |
|------------------------------|--------------------------------|
| Frame rate ¹ | 24, 25, 30, 50, or 60 fps |
| Chroma sampling ¹ | 4:4:4, 4:2:2, or 4:2:0 |
| Color bit depth ¹ | 8 bits per color |
| Signal type | HDMI 1.4, HDCP 2.3 |
| Max. video data rate | 10.2 Gbps (3.4 Gbps per color) |

NOTE: ¹Subject to the maximum data rate limit. Use our calculator at www.extron.com/4KdataRate to determine video parameters supported by this data rate.

VIDEO

HDMI output

| | |
|---------------------|---|
| Maximum pixel clock | 300 MHz |
| Resolution range | Up to 2560x1600* @ 60 Hz or 4K (4096x2160) @ 30 Hz, UHD (3840x2160) @ 30 Hz, 4K/UHD @ 60 Hz with 4:2:0 chroma subsampling (*Reduced blanking) |

VIDEO OUTPUT

| | |
|------------|-----------------------|
| Connectors | 1 female HDMI, type A |
|------------|-----------------------|

INTERCONNECTION BETWEEN TRANSMITTER AND RECEIVER

| | |
|-------------|---------------------|
| Signal type | 1 DTP 230 input |
| Connectors | 1 female RJ-45 jack |

DTP signal

| | |
|------------------------------|---|
| Signal transmission distance | Up to 230' (70 m) using shielded twisted pair (STP) cable or XTP DTP 24 cable |
| 1080p @ 60 Hz | Up to 130' (40 m) using STP cable or XTP DTP 24 cable |
| 2560x1600 @ 60 Hz | Up to 130' (40 m) using STP cable or XTP DTP 24 cable |
| 4K/UHD @ 30 and 60 Hz | Solid conductor, 24 AWG or better |
| Cable requirements | 400 MHz bandwidth STP cable |
| Cable recommendations | |

NOTE: Extron XTP DTP 24 shielded twisted pair cable is strongly recommended for optimal performance.

AUDIO OUTPUT

| | |
|--------------------|-------------------------------|
| Number/signal type | 1 stereo, balanced/unbalanced |
|--------------------|-------------------------------|

GENERAL

| | |
|--------------|--|
| Power supply | External (not included) Input: 100-240 VAC, 50-60 Hz Output: 12 VDC, 1.5 A, 18 watts |
|--------------|--|

Enclosure dimensions

| | |
|--------|---|
| Device | 4.2" H x 1.7" W x 2.2" D (10.7 cm H x 4.3 cm W x 5.8 cm D) |
|--------|---|

Regulatory compliance

| | |
|--|---|
| | c-UL, C-tick, CE**, FCC Class A**, ICES, UL, VCCI Complies with the appropriate requirements of RoHS, WEEE |
|--|---|

NOTE: **CE and FCC testing is conducted with STP cable.

NOTE: Shipping dimensions and weights are available at www.extron.com.

| Model | Version Description | Part number |
|--------------------|--|-------------|
| DTP R HWP 4K 231 D | HDMI Decorator-Style Rx, Black - 230 feet (70 m) | 60-1531-12 |
| DTP R HWP 4K 231 D | HDMI Decorator-Style Rx, White - 230 feet (70 m) | 60-1531-13 |

For complete specifications, please go to www.extron.com
Specifications are subject to change without notice.

WORLDWIDE SALES OFFICES

Anaheim • Raleigh • Silicon Valley • Dallas • New York • Washington, DC • Toronto • Mexico City • Paris
London • Frankfurt • Madrid • Stockholm • Amersfoort • Moscow • Dubai • Johannesburg • Tel Aviv • Sydney
Melbourne • Bangalore • Mumbai • New Delhi • Singapore • Seoul • Shanghai • Beijing • Hong Kong • Tokyo

www.extron.com